

SEÇÕES E PERFIL PROJEÇÃO DE EXPANSÃO DO CANAL

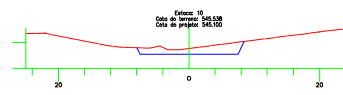

Estação	Cota de terreno	Cota de projeto	Comprimento
1	544,280	543,850	100,000
2	544,300	543,700	100,000
3	544,300	543,700	100,000
4	544,300	543,700	100,000
5	544,900	544,800	100,000
6	544,814	543,800	100,000
7	544,763	543,950	100,000
8	544,576	543,000	100,000
9	544,720	543,000	100,000
10	545,100	545,100	100,000
11	544,900	543,750	100,000
12	544,833	543,000	100,000
13	544,300	543,000	100,000

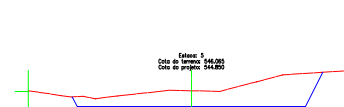
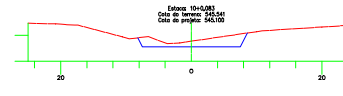
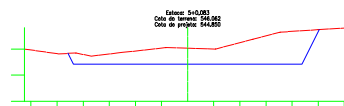
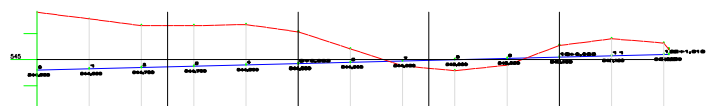
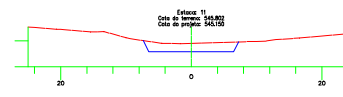
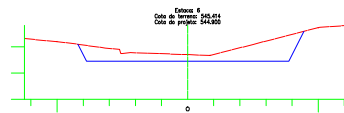
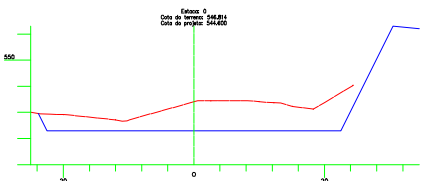
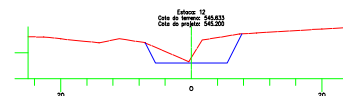
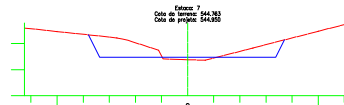
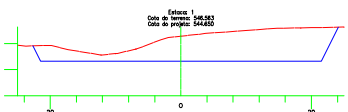
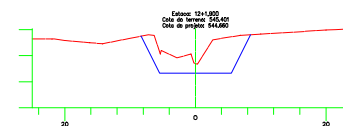
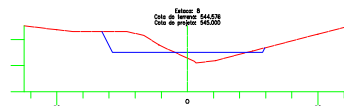
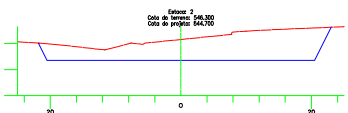
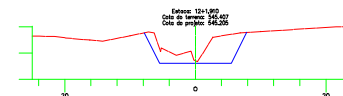
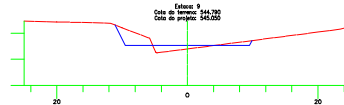
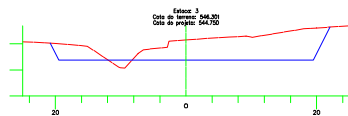
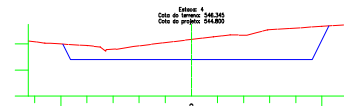
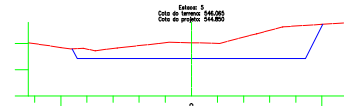

PERFIL LONGITUDINAL E SEÇÕES TRANSVERSAIS

FL UNICA

Proprietário: Prefeitura Municipal de Cocos

Município: Cocos

Comarca: Carinhanha

Estado (UF): SP

Código local:

Matrícula/Processo:

Data: 22/03/2022

Estado: INDICADAS

LEGENDA

- GREIDE PROJETADO
- TERRENO NATURAL

ASSINATURA

PROFESSOR DE CLASSE BACHAREL EM ENGENHARIA CIVIL

CRÉDITO 12080/2010

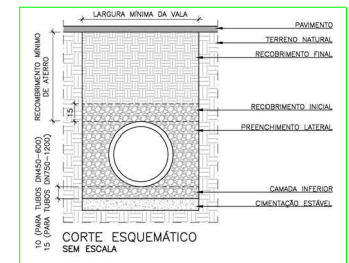
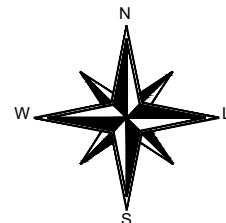
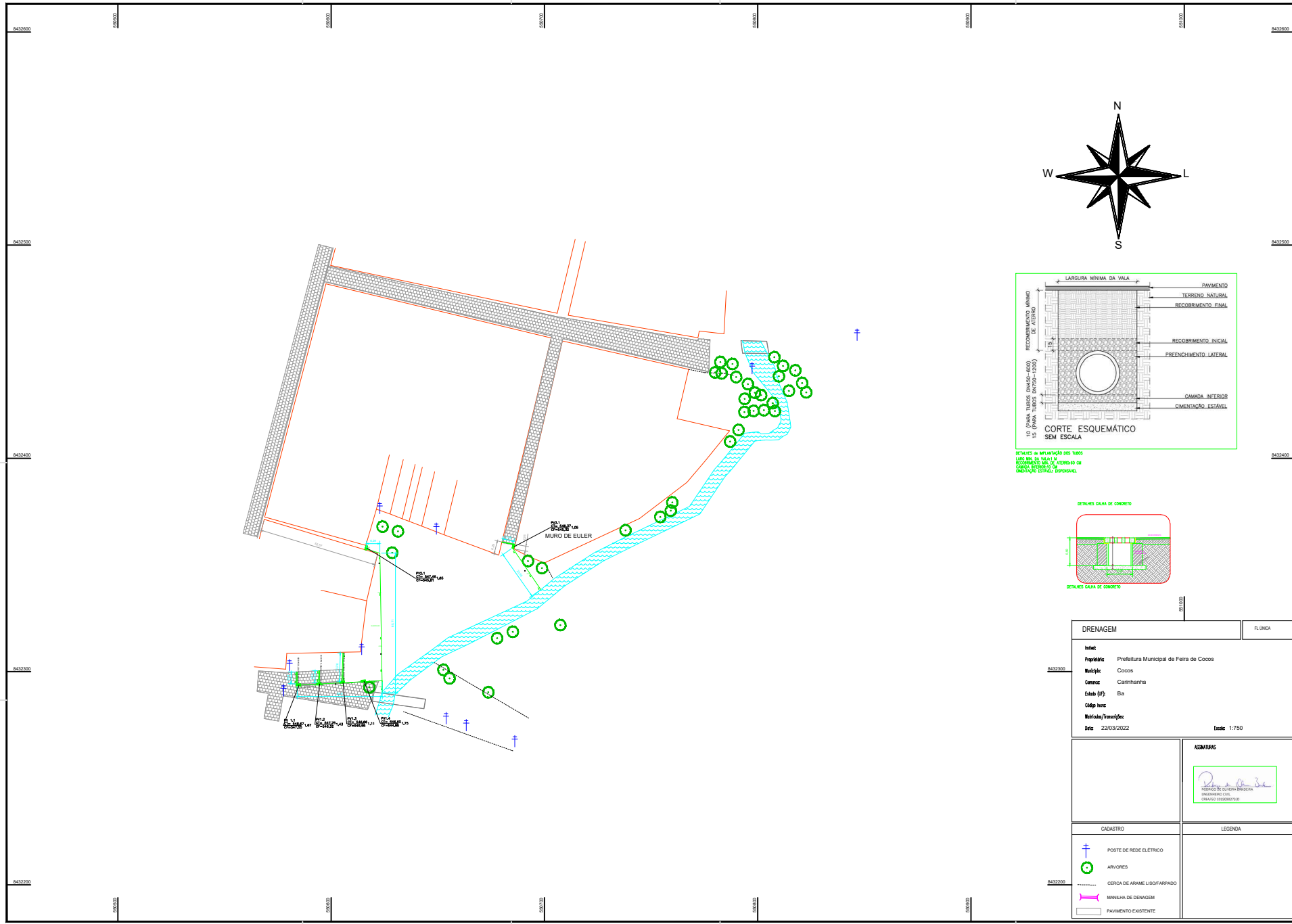

DETALHE DE REFORÇO DO TUBO
 LADO DE LA VILA L N
 DETALHE DO TUBO E TUBO DE
 CADAQUETE DO
 DRENAGEM ESTÁVEL ESPECIAL

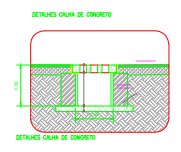

DRENAGEM		FL ÚNICA
Indic: Prefeitura Municipal de Feira de Coços		
Município: Coços		
Comarca: Carinhanha		
Estado (UF): Ba		
Código hora:		
Município/Projetista:		Escala: 1:750
Data: 22/03/2022		
		ASSINATURAS  RONDALDO DE OLIVEIRA BENEÇA ENGENHEIRO CIVIL CRM/BA 102000715
CADASTRO + POSTE DE REDE ELÉTRICO + ÁRVORES - CERCAS DE ARAME LISOFARPADO - MANEIRA DE DRENAGEM - PAVIMENTO EXISTENTE		LEGENDA

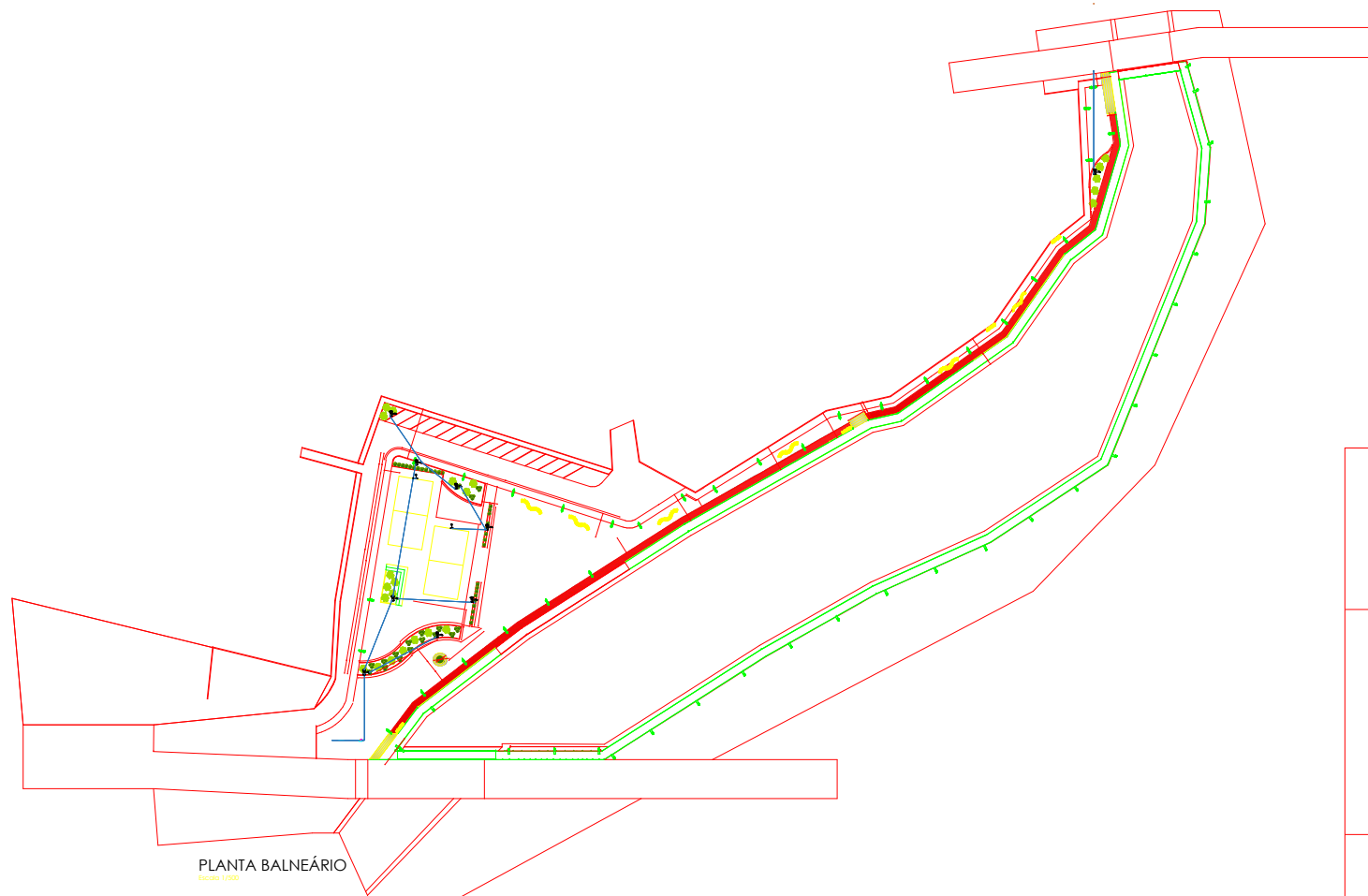

PLANTA BALNEÁRIO

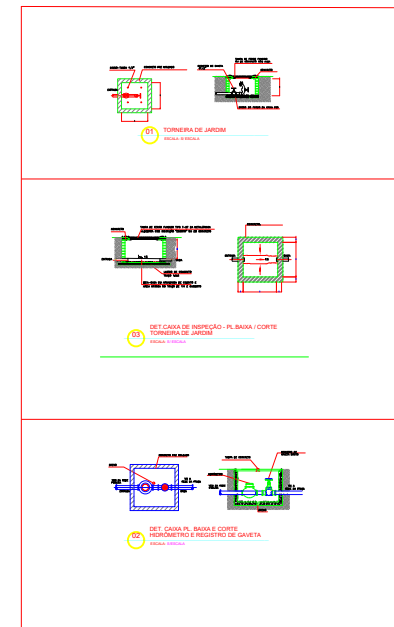

CONSTRUÇÃO DO BALNEÁRIO DE COCOS-BA			
Projeto de Irrigação Balneário			
PLANTA DE IRRIGAÇÃO			IRRG-01
			01/01
PROFESSOR	PROJETA	PROJETO	REVISÃO/COMENTÁRIOS
ALUNO DE 2022	12/11	12/11/2022	12/11/2022

BOCAS-DE-LOBO DUPLAS COM GRELHAS DE CONCRETO

PLANTA

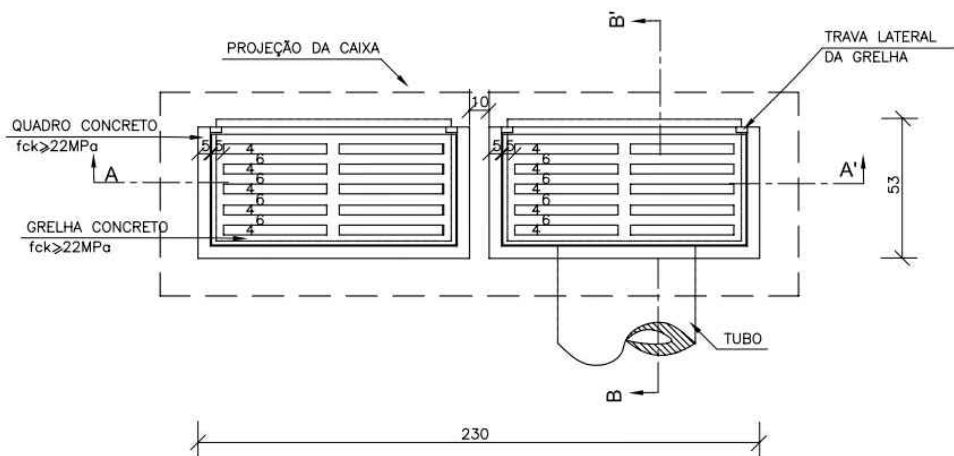

CORTE AA'

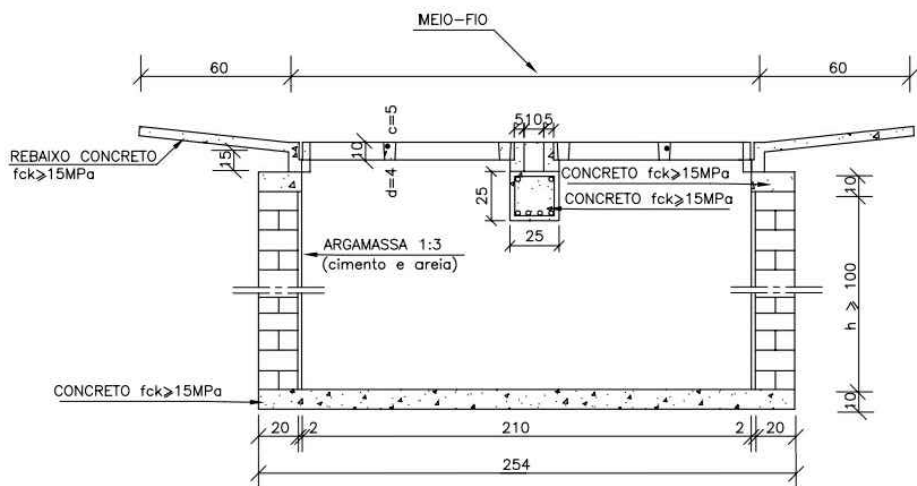

CORTE BB'

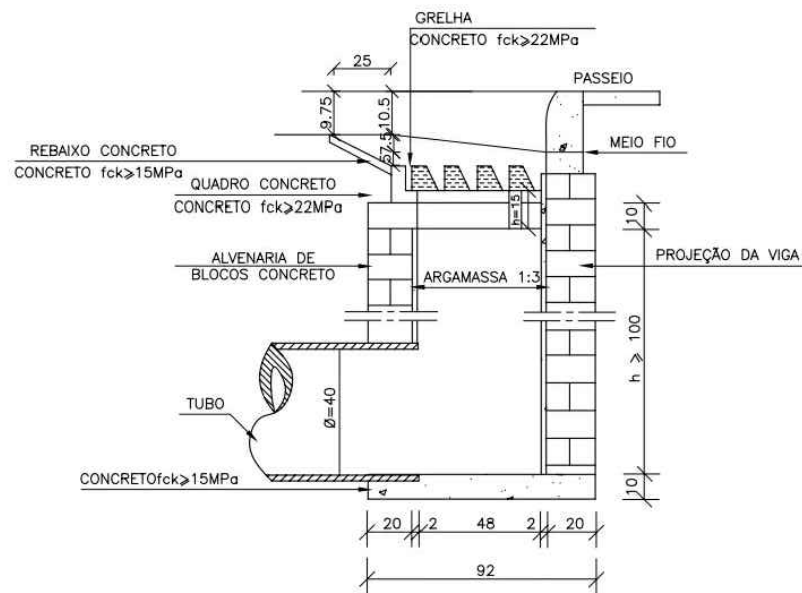

QUANTIDADES MÉDIAS PARA UMA BOCA DE LOBO E ACESSÓRIOS

CÓDIGO	h	ALVENARIA BLOCOS DE CONCRETO	ARGAMASSA 1:3 (m ³)	FORMAS (m ²)	AÇO (kg)	CONCRETO fck ≥ 15MPa (m ³)	CONCRETO fck ≥ 22MPa (m ³)
BLD01	100	6,37	0,11	6,60	15,1	0,460	0,110
BLD02	150	9,43	0,16	6,60	15,1	0,460	0,110
BLD03	200	12,49	0,22	6,60	15,1	0,460	0,110
BLD04	250	15,55	0,27	6,60	15,1	0,460	0,110

NOTAS:

- 1 - Dimensões em cm;
- 2 - As quantidades apresentadas incluem a grelha, o quadro e o rebaixo de concreto.

 RODRIGO DE OLIVEIRA BANDEIRA
 ENGENHEIRO CIVIL
 CREA/GO 1015090273/D

MT DEPARTAMENTO NACIONAL DE INFRA-ESTRUTURA DE TRANSPORTES - DNIT IPR

BOCAS-DE-LOBO DUPLAS COM GRELHAS DE CONCRETO

ALBUM DE PROJETOS-TIPO DE DISPOSITIVOS DE DRENAGEM

DESENHO 5.4

SEÇÃO TRANSVERSAL DOS ACESSOS

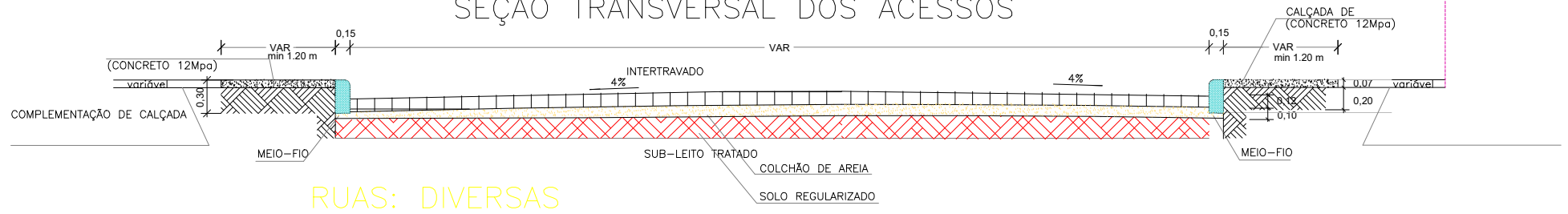

RUAS: DIVERSAS

Rodrigo de Oliveira Bandeira
 RODRIGO DE OLIVEIRA BANDEIRA
 ENGENHEIRO CIVIL
 CREA/GO 1015090273/D

REVISÕES			
REV. Nº	POR	DATA	DESCRIÇÃO

Escala: SEM ESCALA Formato: A4

PROJETO
DETALHES DAS RUAS A PAVIMENTAR
 ENDEREÇO: RUAS DE COCOS-BA

PRANCHA TIPO
SEÇÃO TRANSVERSAL DOS ACESSOS NO BALNEÁRIO

DATA: MARÇO/2018 ENGIARTE: RODRIGO DE OLIVEIRA BANDEIRA/1015090273D-GO

SEÇÕES E PERFIL RUA PROJETADA

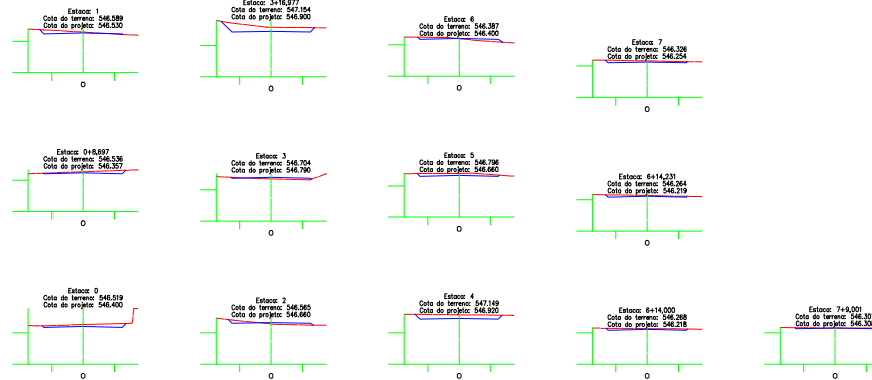
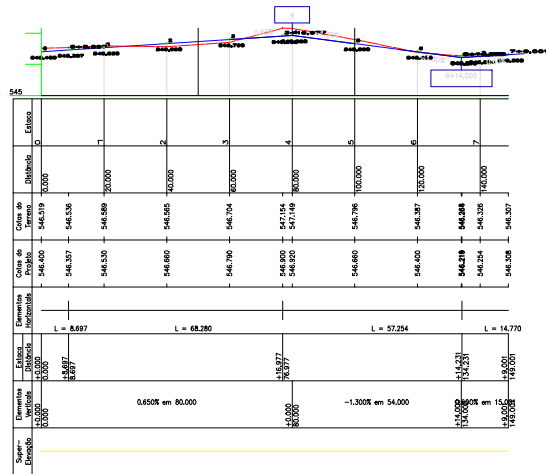

SEÇÕES E PERFIL PRAÇA BALNEÁRIO

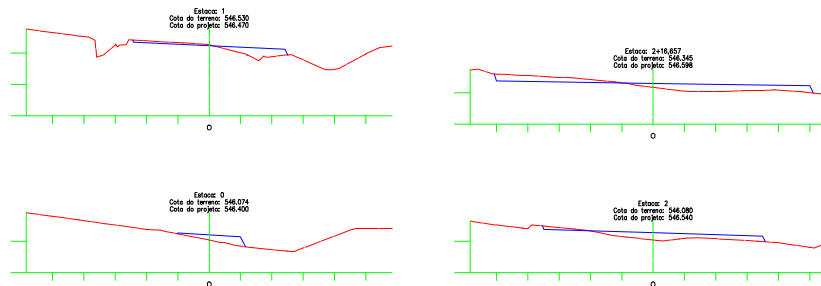
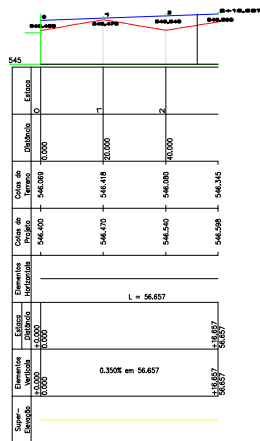

PERFIL LONGITUDINAL E SEÇÕES TRANSVERSAIS		FL UNICA
Proprietário: Prefeitura Municipal de Coos Município: Coos Comarca: Carimãinha Estado (UF): Ba Código Vere: Matrícula/Inscrição: Data: 22/03/2022 Ende: INDICADAS		LEGENDA GREDE PROJETADO TERRENO NATURAL
ASSINATURA ROGÉRIO DE OLIVEIRA BARBOSA ENGENHEIRO CIVIL CRM/BA 103907/2010		